

# LEVEL 16

## Office Building

### 2 Southbank Boulevard

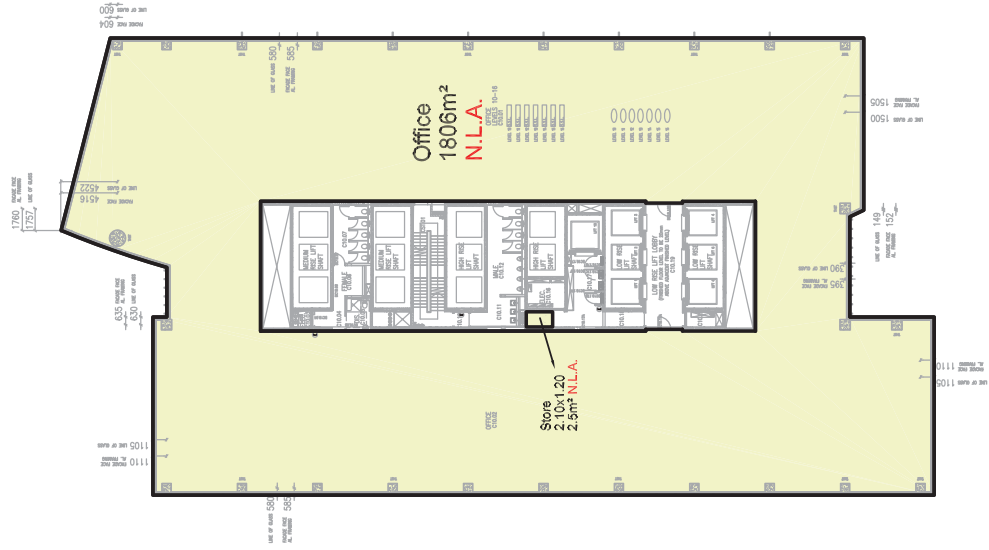
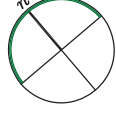

**NOTES**  
 Area and tenancy boundaries have been measured in accordance with the 'Property Council of Australia Method of Measurement for Lettable Area' March 1987 edition  
 Part 3 - Net Lettable Area (N.L.A.)  
 This plan should be read in conjunction with the written report  
 CAD REF: 303800PE.DWG March 2005

**Bosco Jonson Pty Ltd**  
 A.B.N 95 282 532 642  
 P.O. Box 243, South Melbourne, Vic 3205  
 71 Palmerston Crescent South Melbourne  
 Vic 3205 Australia DX 20524 Emerald Hill  
 Tel 03) 9699 1400 Fax 03) 9699 5992

