

LEVEL 15

Office Building

2 Southbank Boulevard

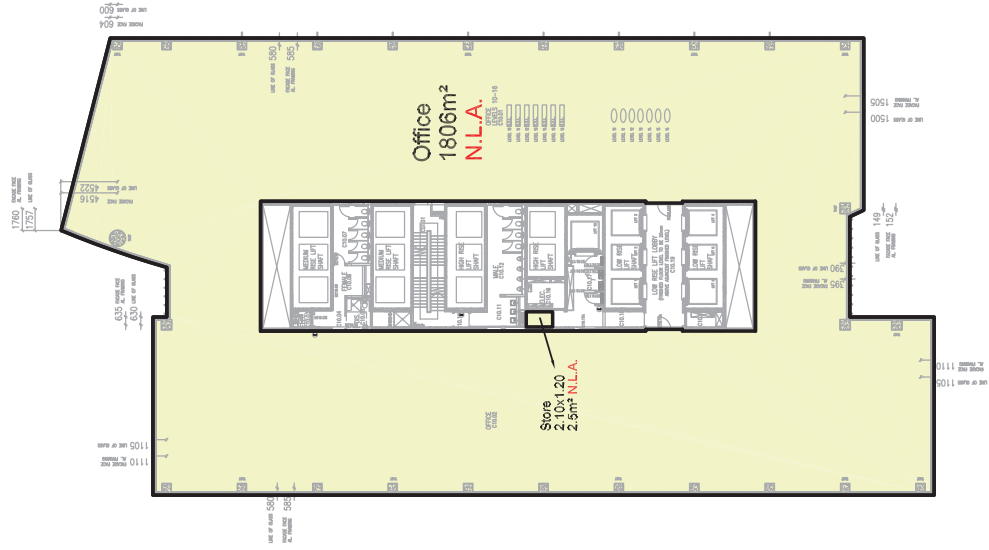
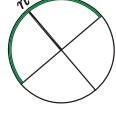

NOTES
 Area and tenancy boundaries have been measured in accordance with the 'Property Council of Australia Method of Measurement for Lettable Area' March 1987 edition
 Part 3 - Net Lettable Area (N.L.A.)
 This plan should be read in conjunction with the written report
 CAD REF: 303800PE.DWG March 2005

Bosco Jonson Pty Ltd
 A.B.N 95 282 532 642
 P.O. Box 243, South Melbourne, Vic 3205
 71 Palmerston Crescent South Melbourne
 Vic 3205 Australia DX 20524 Emerald Hill
 Tel 03) 9699 1400 Fax 03) 9699 5992

